



D4a

Residence 3

Details

Beds	3
Baths	2
Car bays	2
Store	1

Areas

Internal	128m ²
Terrace	34m ²
Total	162m²

Location

Level(s)	Ground
Building	Davenport
Aspect	North

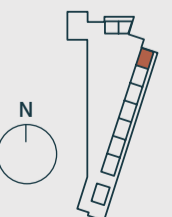

DISCLAIMER: Variations from Strata Plan may apply. Furniture is indicative. Shape and configuration of terraces, doors, windows, screens and ducts may differ from those illustrated. Areas of Residence given are based on architectural measurements. This varies from strata area as it is a different method of measuring the Residence. Plans not to scale.

evkarrinyup.com.au

BLACKBURNE